

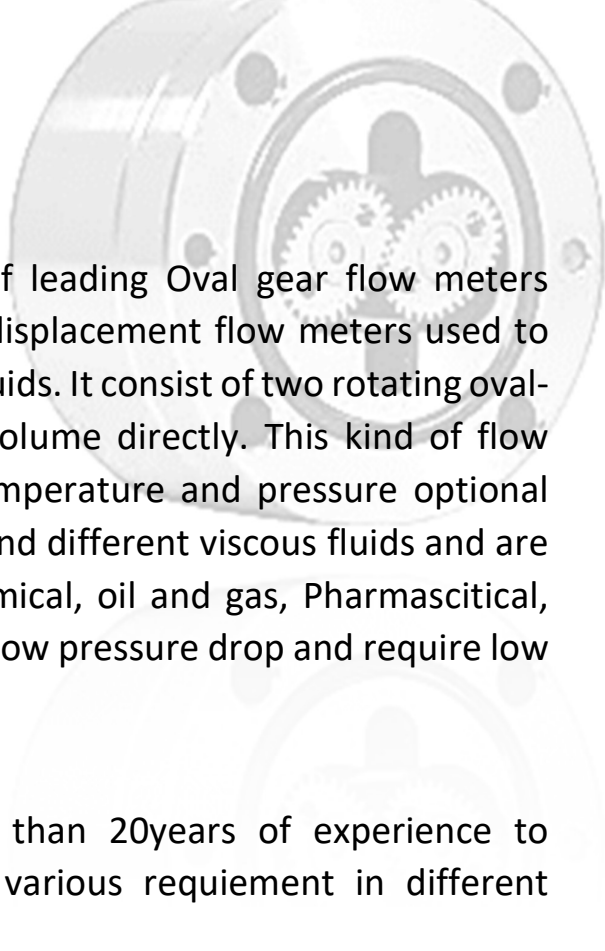

# UNIQUE FLOWSENSE

INTELEGENCE BEHIND EVERY FLOW









Unique Flowsense are one of leading Oval gear flow meters manufacturers which are positive displacement flow meters used to measure the flow rate of various liquids. It consist of two rotating oval-shaped gears that measure fluid volume directly. This kind of flow meter offer high accuracy with temperature and pressure optional and can handle various flow rates and different viscous fluids and are used in various industries like chemical, oil and gas, Pharmascitical, Automotive, paint and more. It has low pressure drop and require low maintenance.

Our technocrates has more than 20years of experience to provide customised solutions for various requiement in different industies.

## Why Unique Flowsense..??

-  More than 20 years of experience in the field of flow meter manufacturing and solution provide.
-  In-House production facilty like cnc machining, wire cut and other convetional machine enable us for better process control.
-  Customer centric approach.
-  Wide range of product with unmatched quality.

## Industries and Application we serve

- Oil and lubricant flow and total Measurement
- Liquid filling and packing machine
- Chemical Flow and total Monitoring
- Pharmaceutical and Food Industries
- Marine Applications
- Hydraulic Systems
- Automotive Industry
- Acid flow Measurement
- Fuel Consumption Monitoring
- Silicone sealant resin gummies material flow measure
- Paint application.



## Product Specification

Oval Gear Flow Meter Features	
Items	Specification
Output	Digital Pulse Output (NPN or PNP Type)
Output Power	12VDC to 24VDC pulse
Accuracy	+/-0.2% of FS
Line Size	1/4" TO Up to 6"
Max Temp	-20°C ~ 80°C (150°C OPTIONAL)
Pressure	<ul style="list-style-type: none"><li>• 30 bar (Aluminum)</li><li>• 80 bar (Stainless Steel) (UPTO 500bar optional)</li></ul>
MOC Selection	<ul style="list-style-type: none"><li>• Body-Aluminum, Ss304, Ss316, ss316l</li><li>• Gear- Aluminum, Ss304, Ss316, ss316l</li><li>• Shaft- ss304, solid carbide</li><li>• Seal - viton</li></ul>
Connection Type	Flange Type, Threaded Type, Tri clover Clamp
cable Type	3 core , length 1 meter to 10 meter
certificate	calibration test certificate



## Product Specification

Flow Meter Features – Flameproof Part code : UFD003	
Items	Specification
Display	<ul style="list-style-type: none"> <li>Graphical Display</li> <li>Character Display</li> </ul>
Output	<ul style="list-style-type: none"> <li>Pulse,</li> <li>4To20 mA,</li> </ul>
Security	Password Protected
Power Supply	24 VDC
Ambient Temperature	0°C to 55°C
Enclosure	Aluminum die cast 110 mm



Flow Totalizer (R1) Part code : UFD001	
Items	Specification
Display	<ul style="list-style-type: none"> <li>Graphical Display</li> <li>Character Display</li> </ul>
Input	<ul style="list-style-type: none"> <li>Digital Pulse</li> <li>4to20mA</li> </ul>
Output	<ul style="list-style-type: none"> <li>Pulse,</li> <li>1 Relay/2Relay</li> <li>4To20 mA,</li> <li>Rs485 Modbus</li> </ul>
Security	Password Protected
Flameproof	No
Power Supply	250VAC / 24VDC (As per Model Selection)
Ambient Temperature	0°C to 55°C
Enclosure	ABS Plastic 96 X 96



Flow Totalizer (R2) Part no : UFD002	
Items	Specification
Display	Graphical Display Character Display
Input	Digital Pulse
Output	<ul style="list-style-type: none"> <li>Pulse,</li> <li>1 Relay</li> <li>4To20 mA,</li> <li>Rs485 Modbus</li> </ul>
Security	Password Protected
Flameproof	No
Power Supply	250VAC
Ambient Temperature	0°C to 55°C
Enclosure	ABS Plastic 150 X 75



# OVEL GEAR TYPE

## FLOW METER



### How to order (Model Selection)

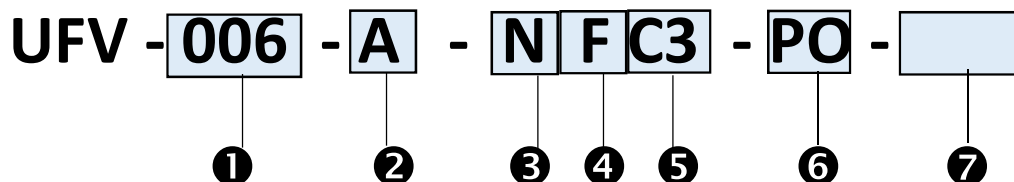

#### ① Model(size)

\*\* Refer table  
1.1 below

#### ② Material

A	Aluminium
S4	SS 304
S6	SS 316

#### ③ Output type

N	NPN
P	PNP

#### ④ Connection Type

F	Flange
T	Threading
C	Tri Clamp

#### ⑤ Cable length

Nil	1meter
C3	3 meter
C5	5 meter

#### ⑥ Display/output

PO	Pulse Output
R1	Remote Display (part UFD001)
IT	Integrated Totaliser (part UFD003)
R2	Remote Display (par UFD002)

\* For more detail of flage please refer table 1.2

#### ⑦ Make to order

Nil	Standard product
Z*	Customised product

Note: refer specification for more detail.

### Technical Datasheet:

Table 1.1

Model	Line size	Thread size	Flow range LPH <sup>Note1</sup>	Flow range LPM
006	6 mm	1/4" BSP	1 - 120 LPH	0.015 - 2 LPM
008	8 mm	3/8" BSP	15 - 500 LPH	0.25 - 8 LPM
012	12 mm	1/2" BSP	100 - 1500 LPH	1.50 - 25 LPM
020	20 mm	3/4" BSP	200 - 2200 LPH	3 - 35 LPM
025	25 mm	1" BSP	500 - 4000 LPH	8 - 65 LPM
025 B	25 mm	1" BSP	500 - 6000 LPH	8- 100 LPM
040	40 mm	1½" BSP	1000 - 10000 LPH	16 - 165 LPM
050	50 mm	2" BSP	5000 - 20000 LPH	83 - 335 LPM
080	80 mm	3" BSP	10000 - 50000 LPH	165 - 835 LPM
100	100mm	4" BSP	20000-75000 LPH	335 - 1250 LPM

Note 1 : Flow rate data reference for the oil having Viscosity 28 mm<sup>2</sup>/s at 40°C

# Fuel consumption Calculator



## How to order (Model Selection)

**UFC - 006 - A - F - C3**

①

②

③

④

① Size

\*\* Refer table  
2.1 at page 3

② Material

A	Aluminium
S4	SS 304

③ Connection Type

F	Flange
T	Threading
C	Tri Clamp

④ Cable length

Nil	1meter
C3	3 meter
C5	5 meter

## Technical Datasheet:

Table 2.1 :

SIZE	Thread size	DIESEL GENERATOR CAPACITY
006	1/4" BSP	200 KW/KVA/HP
008	3/8" BSP	400 KW/KVA/HP
012	1/2" BSP	1000 KW/KVA/HP
020	3/4" BSP	1500 KW/KVA/HP
025	1" BSP	2000 KW/KVA/HP

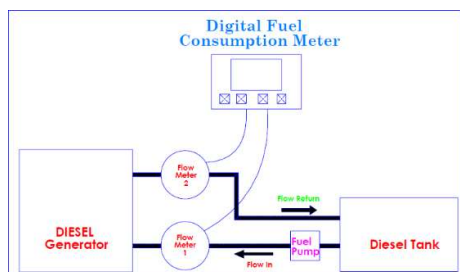

Item	Specification
Display	Graphical Display Character Display
Input	Digital Pulse
Output	<ul style="list-style-type: none"> <li>Rs485 Modbus</li> <li>USB DATA Logging</li> </ul>
Security	Password Protected
Power Supply	12 VDC
Ambient Temperature	0°C to 55°C
Enclosure	ABS Plastic 96 X 96
Accuracy	+/-0.2% of FS
Line Size	1/4", 3/8", 1/2", 3/4", 1"
Max Temp	-20°C ~ 80°C (150°C OPTIONAL)
Pressure	<ul style="list-style-type: none"> <li>30 bar (Aluminum)</li> <li>80 bar (Stainless Steel)</li> </ul>
MOC Selection	<ul style="list-style-type: none"> <li>Body-Aluminum, Ss304, Ss316, ss316l</li> <li>Gear- Aluminum, Ss304, Ss316, ss316l</li> <li>Shaft- ss304, solid carbide</li> <li>Seal - viton</li> </ul>
Connection Type	Flange Type, Threaded Type, Tri clover Clamp
cable Type	3 core , length 1 meter to 10 meter

# DIMENSIONS

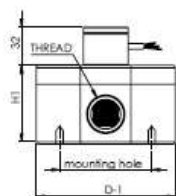

Pulse output Thread

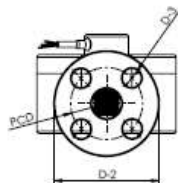
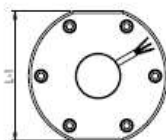

Pulse Output Flange

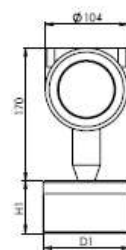
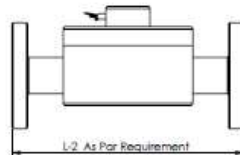

Intigretad Flameproof Display

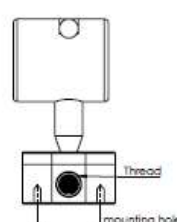

Part no.	H-1	D-1	L-1	Thread	CLASS150 FLANGE	D2	D 3	PCD	MOUNTING HOLE
006	40	62	58	1/4" BSP	1/2"	88.9	15.74X4	60.45	M5 X 46
008	42.5	67	61	3/8" BSP	1/2"	88.9	15.74X4	60.45	M6 X 51
012	49	87	82	1/2" BSP	1/2"	88.9	15.74X4	60.45	M6 X67
020	56	97	91	3/4" BSP	3/4"	98.55	15.74X4	69.85	M6 X 80
025	66	111	103	1" BSP	1"	107.95	15.74X4	79.24	M6 X 90
025 B	76	117	109	1" BSP	1"	107.95	15.7X4	79.24	M6 X 96
040	96	136	124	1-1/2" BSP	1-1/2"	127.0	15.74X4	98.55	M8 X 116
050	116	175	160	2" BSP	2"	152.4	19.05X4	120.65	M10 X 152
080	126	228	220	3" BSP	3"	190.5	19.05X4	152.4	M10 X 204

## **UNIQUE FLOWSENSE**

74, ASHTAVINAYAK INDUSTRIAL PARK,  
NUGAR BYPASS, MEHSANA-384205, GUJARAT.

WEBSITE : [WWW.UNIQUEFLOWSESE.COM](http://WWW.UNIQUEFLOWSESE.COM)

EMAIL ID : [info@uniqueflowsense.com](mailto:info@uniqueflowsense.com)

MOBILE : +91 79902 85545